**OLDSMOBILE MODEL 983336**

UNITED MOTORS

Oldsmobile Model 983336

SPEAKER—POWER SUPPLY UNIT

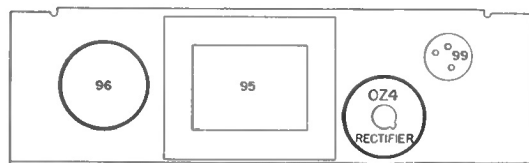

PARTS LAYOUT—TUBE VIEW

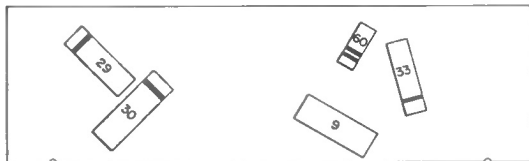

PARTS LAYOUT—CHASSIS VIEW

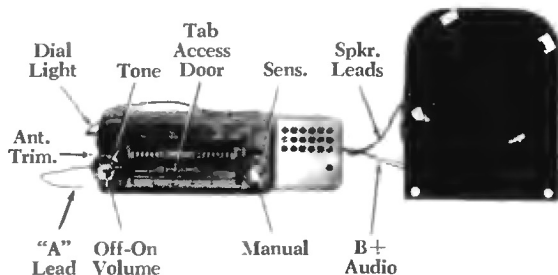

Connect vacuum tube voltmeter between AVC line and ground during alignment.

ALIGNMENT PROCEDURE:

Generator Return Receiver Chassis
 Dummy Antenna In Series With Generator
 Volume Control Maximum Volume
 Sensitivity Control Position 2. (Position 1 is Maximum)
 Tone Control Treble (max. clockwise)
 Generator Output - Not to Exceed 2 Volts at VTVM 111

RF—AUDIO UNIT

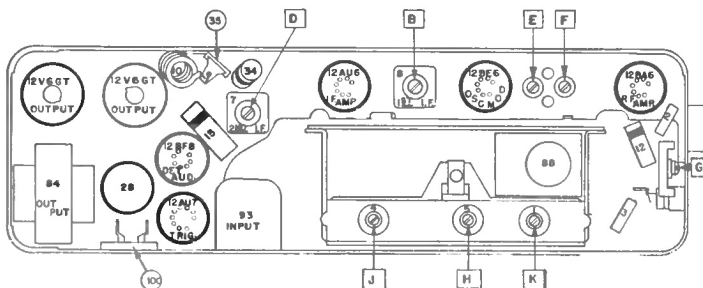

PARTS LAYOUT—TUNER VIEW

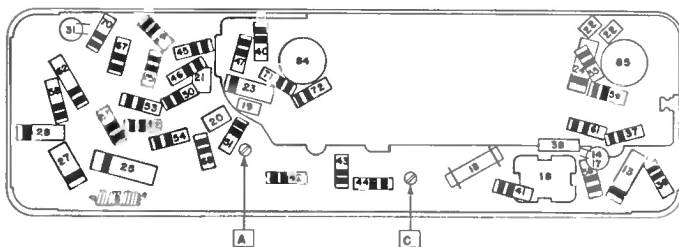

PARTS LAYOUT—CHASSIS VIEW

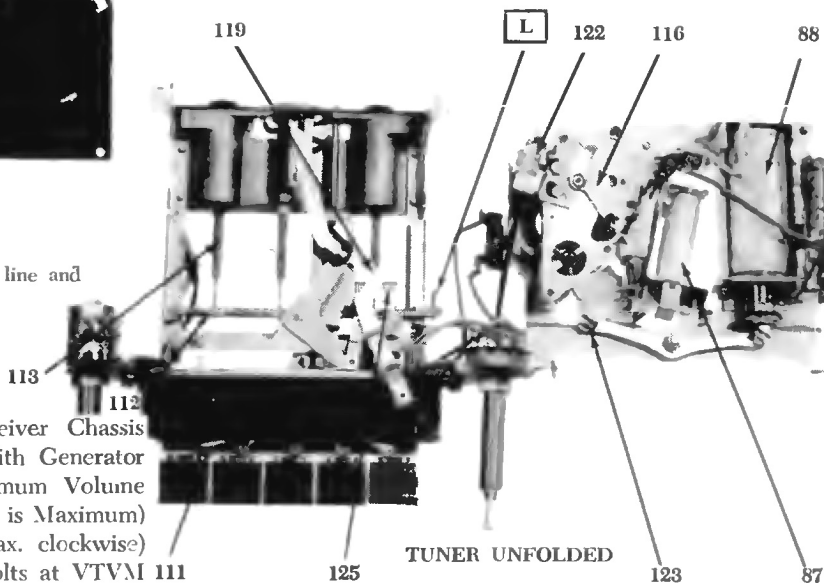

TUNER UNFOLDED

Step	Dummy Antenna	Connect To	Signal Generator Frequency	Tune Receiver To	Adjust in Sequence
1	0.1 mfd.	12BE6 Grid (Pin 7)	262 KC	*High Frequency Stop	A, B, C (Max.)
2	0.1 mfd.	12BE6 Grid (Pin 7)	262 KC	High Frequency Stop	D (Min.)
3	0.000068 mfd.	Antenna Connector	1615 KC	High Frequency Stop	**E, F, G (Max.)
4	0.000068 mfd.	Antenna Connector	600 KC	Signal Generator Signal	J, K (Max.)
5	0.000068 mfd.	Antenna Connector	1615 KC	Signal Generator Signal	F, G (Max.)
6	0.000068 mfd.	Antenna Connector	1000 KC	Signal Generator Signal	***L

*To tune to high frequency, put a 0.070" feeler gauge (or bare #13 wire) in slot against the high frequency stop. (See tuner pictures). Turn manual control to allow the planetary arm to run against the feeler gauge.

**Before making this adjustment, check the setting of oscillator core "H." The rear of the core should be $1\frac{1}{8}$ " from the mounting end of the coil form. This measurement is readily made by inserting a suitable plug in the mounting end of the coil form. The core adjustment is made from the mounting end of the coil form with an insulated screw driver. (It will be necessary to steady the core guide bar by applying a downward pressure at the antenna core end of the bar while making these adjustments.) If this adjustment is necessary, first dissolve the glyptal seal on the core stud and be sure to re-seal after making the adjustment.

***"L" is the pointer adjustment screw on the end of the core guide bar — adjust so pointer reads 1000 KC.

With the radio installed and the antenna plugged in, adjust the antenna trimmer "C" for maximum volume with the radio tuned to a weak station between 600 and 1000 KC (see sticker on case).