

# Technical Manual

# 4312EBK R/L



### ACOUSTIC & ELECTRICAL SPECIFICATIONS:

- Nominal impedance: 6 ohms
- Maximum amplifier power: 200W (RMS)\*
- Frequency response: 40Hz – 40kHz (–6dB, half space)
- Sensitivity: 93dB (2.83V/1m)
- Crossover frequencies: 2.0kHz, 5.0kHz

### SYSTEM COMPONENTS:

- Cabinet: 4312EBK cabinet R/L (not for sale)
- Grille: 4312EBK front grille (444060-001)
- Low-frequency transducer: 12" (305mm) 2213Nd-2 (444709-001)  
DC resistance: 4.6 ohms ±10%
- Mid-frequency transducer: 4" (101mm) 105H-1 (443970-001)  
DC resistance: 4.5 ohms ±10%
- High-frequency transducer: 1" (25mm) 054ALMG (443971-001)  
DC resistance: 3.5 ohms ±10%
- Crossover network 352980-001

### AURAL-SWEEP TEST SPECIFICATIONS:

- System aural sweep test: 6.0V input 50Hz to 20kHz
- L.F. aural sweep test: 5.0V input 50Hz to 2.5kHz
- M.F. aural sweep test: 4.0V input 1kHz to 6kHz
- H.F. aural sweep test: 2.83V input 4kHz to 20kHz

### PHYSICAL SPECIFICATIONS:

- Dimensions (W x H x D): 14-1/4" x 23-1/2" x 11-3/4" with grille  
(362mm x 597mm x 298mm with grille)
- Weight: 39.5 lb (17.9kg) each

### WARRANTY:

- Refer to the warranty statement packed with the product.

\* The maximum recommended amplifier power rating will ensure proper system headroom to allow for occasional peaks. We do not recommend sustained operation at these maximum power levels.

## PACKAGING

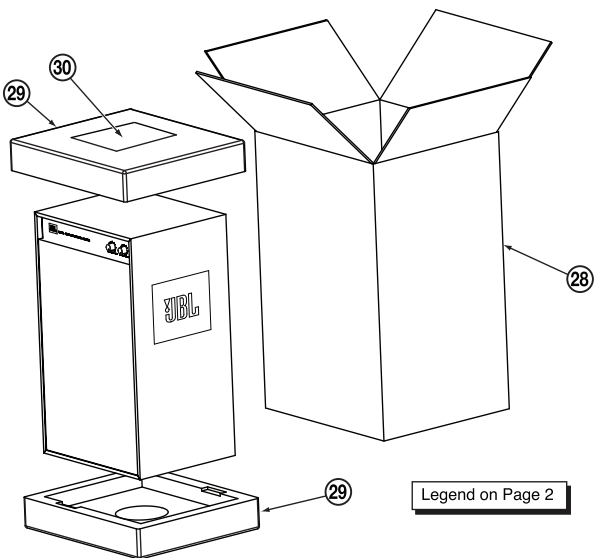

Legend on Page 2

## 4312E WIRING DIAGRAM

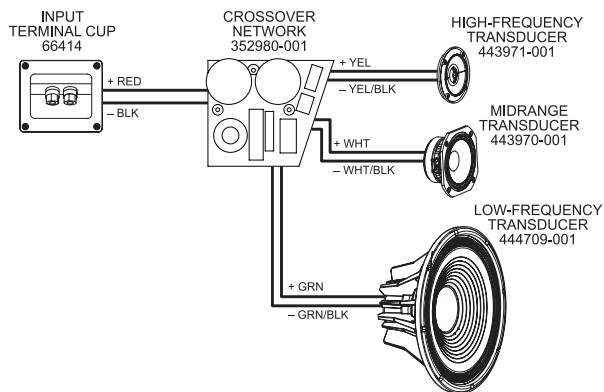

## 4312E SCHEMATIC

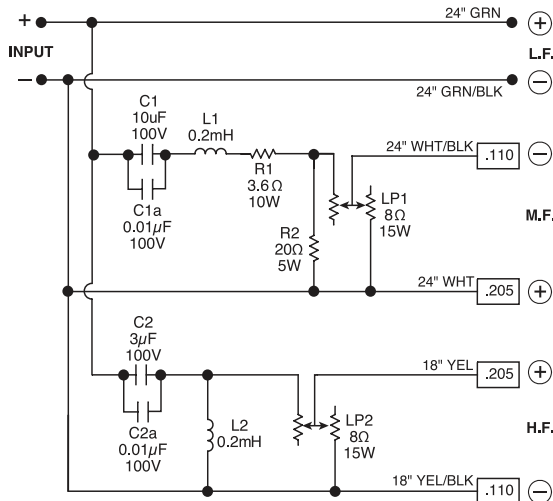

4312EBK R/L

# Technical Manual

# 4312EBK R/L



## EXPLODED VIEW (4312EBK L SHOWN)

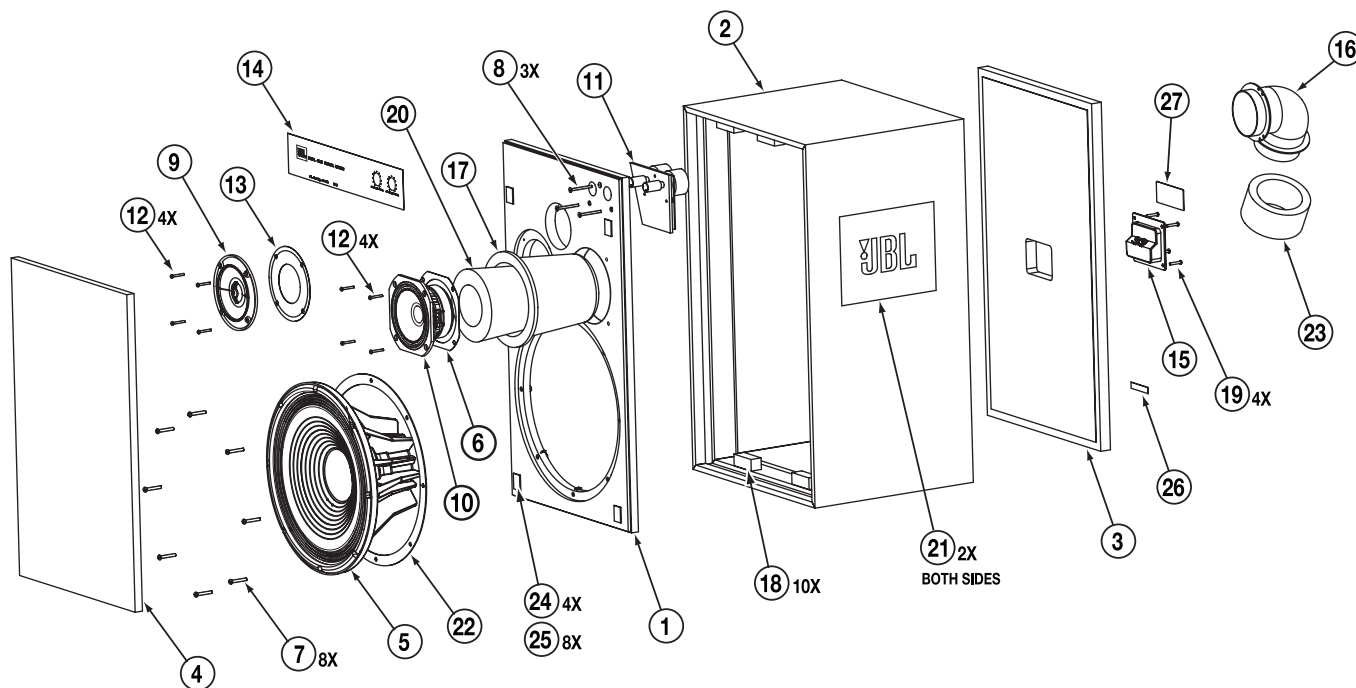

ITEM NO.	PART NO.	DESCRIPTION	QTY.	ITEM NO.	PART NO.	DESCRIPTION	QTY.
1	NOT FOR SALE	PANEL, FRONT, FINISHED - 4312E	1	16	52211	PORT TUBE, PLASTIC ELBOW, 2.75" ID, 1/16" THICK	1
2	NOT FOR SALE	ASSEMBLY, CABINET WRAP - 4312EBK	1	17	76041	POT, FLOWER	1
3	NOT FOR SALE	PANEL, REAR, CABINET - 4312E	1	18	NOT FOR SALE	BLOCK, GLUE, 3/4" SQ X 2" L	10
4	444060-001	ASSEMBLY, GRILLE - 4312E	1	19	882-51110-12	SCREW, 6 X 3/4", OV, PH, PTCL, BLK ZC, LCS - FOR TERMINAL CUP	4
5	444709-001	ASSEMBLY, WOOFER, DUAL COIL/DUAL GAP, 12", 2213-ND-2	1	20	NOT FOR SALE	MIDRANGE CUP WRAP	1
6	353024-001	GASKET, BD, CHIP - 105H FOR MIDRANGE	1	21	68594	LOGO, JBL, WHITE, TRANSFER, VINYL	2
7	804-41100-16	SCREW, 10-32 X 1", PAN HEAD, PHILLIPS, CLEAR ZINC, LCS - FOR WOOFER	8	22	335481-002	GASKET, CHIPBD, 0.015" - 4312E - FOR WOOFER	1
8	803-11110-20	SCREW, 8-32 X 1-1/4", FLT, PH, BLK ZC, LCS - FOR L-PAD	3	23	NOT FOR SALE	PORT TUBE WRAP	1
9	443971-001	ASSEMBLY, TWEETER, 054ALMG	1	24	NOT FOR SALE	TAPE PILE, (VELCRO) SCOTCHMATE, 3M, #3538, 19.1mm (3/4") L X 25.4mm (1") W - FOR GRILLE	4
10	443970-001	ASSEMBLY, MIDRANGE, 105H-1	1	25	NOT FOR SALE	STAPLE FOR (VELCRO) SCOTCHMATE	8
11	352980-001	ASSEMBLY, CROSSOVER NETWORK - 4312E	1	26	NOT FOR SALE	LABEL, "MADE IN MEXICO", JBL	1
12	883-41110-16	SCREW, 8 X 1", PAN, PH, PB, BLK ZINC, LCS - FOR MIDRANGE AND TWEETER	8	27	NOT FOR SALE	LABEL, FOILCAL - 4312EBK	1
13	353025-001	GASKET, PAPER, 054TI - FOR TWEETER	1	28	444031-001	CARTON, OUTER - 4312E	1
14	NOT FOR SALE	FOILCAL - 4312EBK	1	29	47218-01	PAD, END, TOP & BOTTOM - 4312E	2
15	66414	TERMINAL CUP	1	30	SEE WWW.JBL.COM	OWNER'S MANUAL - 4312E	1

4312EBK R/L

HARMAN Consumer, Inc.  
8500 Balboa Blvd., Northridge, CA 91329 USA

© 2010 HARMAN International Industries, Incorporated. All rights reserved. JBL is a trademark of HARMAN International Industries, Incorporated, registered in the United States and/or other countries. Features, specifications and appearance are subject to change without notice.

10/10  
www.jbl.com